

---

# MULTI-MODEL STRUCTURAL PERFORMANCE MONITORING

AUTHORS

**James-A. Goulet<sup>1</sup>, Prakash Kripakaran<sup>2</sup>, Ian F. C. Smith<sup>3</sup>**

ABSTRACT

Measurements from load tests may lead to numerical models that better reflect structural behavior. This kind of system identification is not straightforward due to important uncertainties in measurement and models. Moreover, since system identification is an inverse engineering task, many models may fit measured behavior. Traditional model updating methods may not provide the correct behavioral model due to uncertainty and parameter compensation. In this paper, a multi-model approach that explicitly incorporates uncertainties and modeling assumptions is described. The approach samples thousands of models starting from a general parameterized finite element model. The population of selected candidate models may be used to understand and predict behavior, thereby improving structural management decision making. This approach is applied to measurements from structural performance monitoring of the Langensand Bridge in Lucerne, Switzerland. Predictions from the set of candidate models are homogenous and show an average discrepancy of 4 to 7% from the displacement measurements. The tests demonstrate the applicability of the multi-model approach for the structural identification and performance monitoring of real structures. The multi-model approach reveals that the Langensand Bridge has a reserve capacity of 30 % with respect to serviceability requirements.

---

<sup>1</sup> PhD Student, James.Goulet@epfl.ch, IMAC, Swiss Federal Institute of Technology (EPFL), Station 18, Bâtiment GC, CH- 1015, Lausanne, Switzerland

<sup>2</sup> PhD, Prakash.kripakaran@epfl.ch, IMAC, Swiss Federal Institute of Technology (EPFL), Station 18, Bâtiment GC, CH- 1015, Lausanne, Switzerland

<sup>3</sup> Professor, F. ASCE, Ian.Smith@epfl.ch, IMAC, Swiss Federal Institute of Technology (EPFL), Station 18, Bâtiment GC, CH- 1015, Lausanne, Switzerland

## KEYWORDS

**Structural Identification, Bridge Behavior, Static Measurement, Multi-Model, Data Interpretation, Uncertainties, Dynamic Behavior**

## 1. INTRODUCTION

Bridges are designed according to codes that specify conservative limits on loading and material properties. Behavioral models used in design, while leading to safe and serviceable structures, are not intended for data interpretation and long-term management. The Langensand Bridge is a good example of innovative structural engineering using composite design. During the design stage, engineers made justifiably conservative assumptions regarding behavioral aspects such as composite action and support conditions. Behavioral models using these assumptions often underestimate the load-bearing capacity of the bridge. Static load-tests may lead to numerical models that more accurately reflect real structural behavior. Such models enable owners to compare predictions with measurements of structural performance and thus take effective future management decisions. For example, when evaluating the effects of increased traffic loading in the future, predictions of a model that reflects real service behavior may indicate that no strengthening is necessary. The ability of a bridge to sustain exceptional loads may also be assessed with such models. Another benefit could involve suspected deterioration in the future. Measurements taken from a new set of static load-tests may be able to flag damage initiation phases when they are compared with predictions from an accurate behavior model. Engineers can then initiate corrective action early, thereby avoiding costly repairs when problems become more apparent. An extended list of potential applications is also reported by Brownjohn (2007).

Static and dynamic load-tests are not new. Measurements have been used for example to update parameters of bridge models (Banan and Hjelmstad 1994; Brownjohn et al. 2003; Sanayei and Saletnik 1996). The objective is generally to tune model parameters such that predictions fit measured data. However, updating may not bring out trustworthy information about the behavior of a structure. The ASME committee for verification and validation (ASME 2006) recommends that an updated

model should only be used for comparison purposes. Predictions for new load cases may be inaccurate. An updated model is also not valuable for observing the evolution of structural properties (ex: creep or structural change).

System identification (*SI*) is the science of inferring models from observations (Ljung 1999). Several system identification approaches have been applied to full-scale civil engineering structures (Brownjohn et al. 2003; He et al. 2009; Morassi and Tonon 2008; Teughels and De Roeck 2004). Most of these methods are based on dynamic testing which have their strength and weaknesses. One of the main reasons for conducting these tests is their ease of use. For example, ambient vibration may be recorded without interrupting traffic. However, dynamic measurements are sensitive to environmental changes. This reduces their potential to correctly identify the behavioral model of a structure or to detect damage. Moreover, all significant modes may not be identifiable from ambient vibration measurements. He et al. (2009) notes the advantage of several system identification methods for cross validation purposes in order to reduce the number of missing modes. Brownjohn and Xia (2000) report that when performing ambient vibration monitoring, fundamental hypothesis requiring input nonstationarity is inevitably violated. Therefore, it is difficult to distinguish between features that are related to the input excitation and those that are related to structural response. Moon and Aktan (2006) conclude that independent approaches must be employed (i.e., comparison of static and modal flexibility) to ensure that identification is reliable.

While the presence of uncertainties has been widely acknowledged in literature (Beck and Katafygiotis 1998; Brownjohn and Xia 2000; Catbas et al. 2008; Hadidi and Gucunski 2008; Raphael and Smith 1998) some approaches overlook uncertainties in the system identification process and focus on finding models such that predictions fit measurements. These approaches are susceptible to error compensation. The wrong model may be identified due to compensating measurement and modeling errors. Inverse tasks are also prone to parameter compensation. For example, in a composite girder, the effect of a large value for the Young's modulus of steel could be compensated by a smaller value for Young's modulus of concrete.

To address the challenges associated with errors and parameter compensation inherent to inverse tasks, Raphael and Smith (1998) proposed the multi-model approach. This method attempts to explicitly take into account all sources of uncertainties identified during the modeling and measurement process. The method differs from deterministic model updating approaches in that it searches for multiple candidate models that explain the measurements taken from a structure. Threshold values on model predictions determine whether or not a generated model is a candidate. Raphael and Smith (2003) used a stochastic search (PGSL) to identify potential behavioral models. Robert-Nicoud et al. (2005b) successfully applied the method on a laboratory benchmark beam. Robert-Nicoud et al. (2005b) determined threshold values by adding the estimated values for modeling and measuring uncertainties. A model is selected as a candidate model if its predictions lie below threshold values at each prediction location for each load case. This process usually leads to a population of candidate models from which further models can only be eliminated using user judgment, supplementary measurements and non-destructive testing.

Saitta et al. (2008; 2009) introduced data mining techniques in order to search more effectively within the space of candidate models. For example, K-means was used to group similar models into more general behavioral classes. Saitta et al. (2008) also used results from data mining to identify subsequent locations for measurements such that a maximum number of models may be eliminated from the population of candidate models. Thus, the multi-model approach enables an iterative strategy of system identification where measurements are used to identify populations of candidate models and which is used to identify subsequent measurement locations. However, the approach has been illustrated using only laboratory tests and simulations. It has not been previously applied for structural identification tasks on full-scale structures. The uncertainties present during the various steps of measurement and modeling of full-scale structures have not been fully assessed.

Building on previous work done at EPFL, this paper develops and improves the multi-model approach in order to make it suitable for structural performance monitoring of full-scale structures. The goals of this study are to investigate the applicability of the multi-model *SI* approach to full-scale structures

and to evaluate the approach for condition assessment of structures. The paper presents results from static load tests performed on the newly built Langensand Bridge in Switzerland. The multi-model approach is used to identify candidate behavioral models able to predict the reserve capacity of the bridge. This paper is organized in five sections. The following section describes the multi-model framework. Next, the testing process and the results obtained from the structural performance monitoring of the Langensand Bridge are discussed. Specifically, results from data interpretation using a multi-model structural system identification methodology are given. Results from the multi-model *SI* approach are then compared with those from a model-updating technique. Lastly, conclusions from the study and avenues of future work are presented.

## 2. SYSTEM IDENTIFICATION USING MULTI-MODEL APPROACH

Recent developments in the field of computing enable the use of computation-intensive approaches for interpreting measurements from static load-tests. Performing thousands of finite element simulations to identify a good set of candidate models is now feasible. The set of candidate behavioral models can be used to understand structural behavior and support predictions. The *SI* framework used in this study is presented in Figure 1. It is adapted from previous work done at EPFL (Raphael and Smith 1998; Robert-Nicoud et al. 2005a) to systematically deal with uncertainties arising in static-load tests of full-scale structures.

### MODEL GENERATION

The first step in the *SI* process is the development of a general finite element model (*GM*) of the studied structure. This model is parameterized according to behavioral assumptions. Examples of model parameters are material properties, partial interaction in a composite structure and damage location. The values of model parameters are determined by probability density functions defined using a priori knowledge. The Latin Hypercube sampling (*LHS*) method is used to generate the models. This method was first proposed by McKay et al. (1979) in order to improve the efficiency of Monte-Carlo methods when used with direct (random) sampling methods. *LHS* allows for sampling in

multi-dimensional space while avoiding clusters. In the present case the sampling approach is not used for probability evaluation purposes, but for sampling in the whole solution space as uniformly as possible, avoiding model clusters. The method start from the general model (*GM*) and uses LHS to generates several potential behavioral models (*PM*) that have different set of values for model parameters.

**LOAD TESTS**

Static-load tests are performed on the structure in order to measure its behavior. Measurements are recorded at many locations (*i*) for each load case (*j*). The measurement locations and load cases may be determined on the basis of predictions from models obtained in the previous step (Robert-Nicoud et al. 2005a).

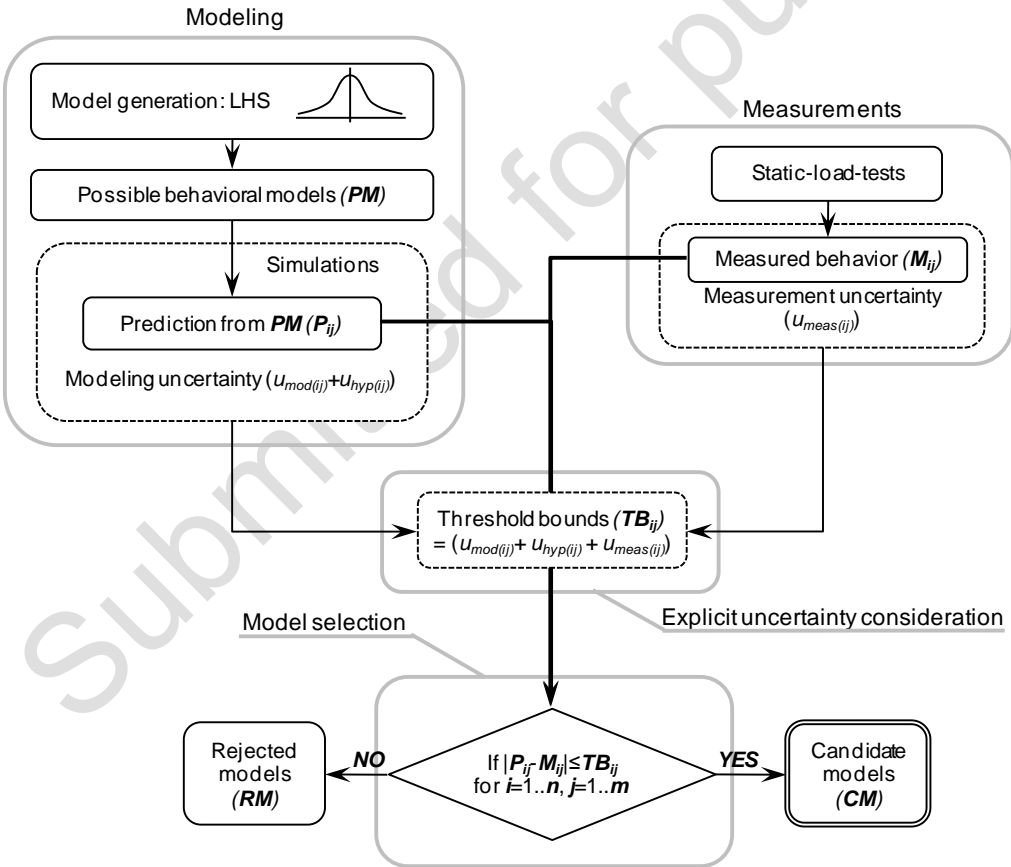

**FIGURE 1 - CANDIDATE MODEL SELECTION PROCESS**

## UNCERTAINTIES AND THRESHOLD VALUES

Uncertainties are present in every stage of the process that is outlined in Figure 1. They may be classified into two categories: measurement uncertainties and modeling uncertainties. The latter consists of hypothesis and modeling uncertainties. Both measurement and modeling uncertainties may include aleatory and epistemic. Oberkampff et al. (2002) reviewed the definition of key terms associated with uncertainties and errors. Uncertainty refers to the concept of an unknown which can be characterized upon examination. Uncertainties are divided in two part: aleatory and epistemic. Aleatory uncertainties are referred as the irreducible ones. They describe the inherent variation associated with physical systems (ex: uncertainty in: material properties, element size and geometry or variation between subsequent measurements of the same quantity). Epistemic uncertainties are attributed to a lack of knowledge. This one is considered to be reducible (ex: uncertainty in: the weight of a truck, finite element modelling or temperature effect occurring during a load test. Up to now, in most cases, only aleatory uncertainties are addressed. Epistemic ones are usually assumed to be zero which for real engineering tasks is seldom true. However, upper bounds of epistemic uncertainties may usually be quantified by performing appropriate observations (ex: uncertainty on the weight of a truck).

In this study, uncertainties are generally expressed as percentages. The measurement uncertainty at a given location for a given load case is evaluated as the product of the measured value and the percentage uncertainty. Similarly, modeling uncertainties are evaluated as the product of the percentage uncertainty and predicted values. The main sources of uncertainties are identified below. The label (A) or (E) identify whether the uncertainty is due to aleatory or a epistemic source.

### MEASUREMENT UNCERTAINTIES ( $U_{MEAS(IJ)}$ )

- Sensor accuracy (A)
- Site conditions, cable and contact losses (A)
- Structure and sensor movement from ambient vibrations (A)
- Repeatability of measurements and truck positioning (A)
- Uncertainty over the truck weight (E)

- Temperature effects (E)

#### HYPOTHESIS AND MODELING UNCERTAINTIES ( $U_{MOD(IJ)}$ , $U_{HYP(IJ)}$ )

- Finite element method (FEM) approximation (E)
- Mesh discretization (E)
- Uncertainties in geometry (E)
- Assumption of linear elastic structural behavior (E)
- Assumption that bearing devices and loads are acting as point loads (E)

Specific threshold bounds ( $TB_{ij}$ ) are computed for each combination of location ( $i$ ) and load case ( $j$ ) by adding the upper bounds of uncertainty terms  $u_{mod(ij)}$ ,  $u_{hyp(ij)}$  and  $u_{meas(ij)}$ . Candidate behavioral models are selected by comparing the difference between predicted ( $P_{ij}$ ) and measured values ( $M_{ij}$ ) to the associated threshold value ( $TB_{ij}$ ).

#### CANDIDATE MODELS

Each model in PM is analyzed for all load cases ( $j$ ) and the predictions ( $P_{ij}$ ) at locations  $i$  are recorded. Candidate models are those models which are able to predict the measured values to within a threshold value ( $TB_{ij}$ ) at each measurement location ( $i$ ) and load case ( $j$ ). The selection process is schematically illustrated in Figure 1.

If the absolute value of the difference ( $P_{ij}-M_{ij}$ ) is smaller than the threshold value ( $TB_{ij}$ ) at every location and for every load case, the model is considered as a *candidate behavioral model (CM)*. Each *CM* thus represents a possible behavioral model of the bridge which may explain the measurements taken on site. The set of candidate models includes the correct behavioral model for the structure and those that have uncertainty compensation since all these models give predictions lower than the threshold value. Models presenting obvious parameter compensation may be rejected using engineering judgment and experience. Lower and higher values for each parameter must be sampled in the initial model set in order to search over the full space of possible solutions. However a candidate model having parameter values such as abnormally low Young's modulus for concrete combined with an abnormally high value for say steel Young's modulus is highly improbable. Even if unlikely, these combinations of low or high parameters must be tested in case they would result to be the only



selected candidate models. They would therefore raise a flag indicating that more candidate models must be evaluated or a more detailed evaluation of the structure is required.

### 3. PERFORMANCE MONITORING OF LANGENSAND BRIDGE

This section describes results from structural system identification using a multi-model approach of the Langensand bridge in Switzerland.

#### 3.1. DESCRIPTION OF BRIDGE AND STATIC-LOAD-TESTS

The new Langensand Bridge in Lucerne (Switzerland) is a single span 80m long structure. Its slenderness ratio ( $L/h$ ) varies from approximately 60 at the abutment to 33 at mid-span. Figure 2 shows the main girder profile and its boundary conditions.

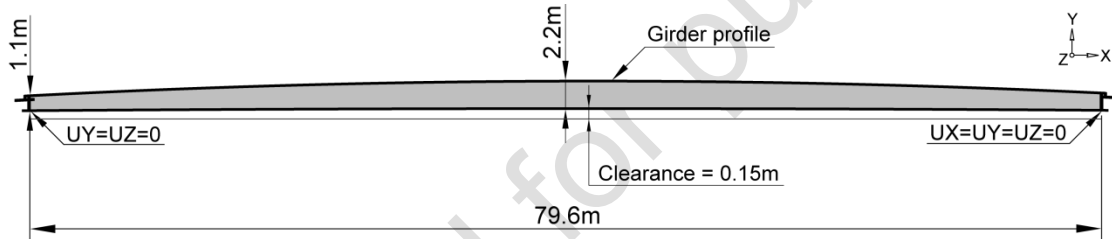

FIGURE 2 - LANGENSAND BRIDGE: MAIN GIRDER PROFILE

The structure is being built in two phases to avoid traffic interruption on the existing bridge. Load tests were performed after the completion of the first phase when only a half of the bridge was completed (see Figure 3).

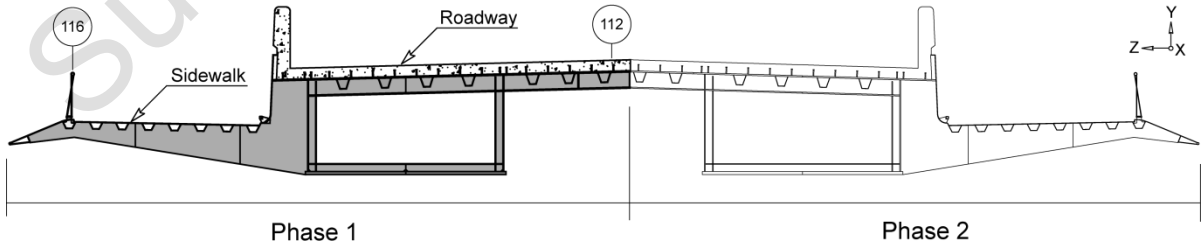
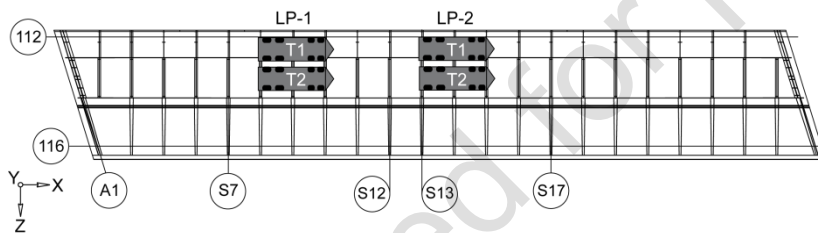

FIGURE 3 - CONSTRUCTION PHASES OF LANGENSAND BRIDGE

Understanding the structural behavior of this bridge is not straightforward due to the following aspects. First, the structure has an unusually high slenderness ratio ( $>L/30$ ). Moreover, the cross section of the bridge is non-uniform, and the geometry of the structure is also slightly arched in elevation along its length. This particular geometry makes the free end of the structure move farther from the fixed end when subject to loading. Furthermore, this structure has a skew of seventeen degrees at abutments.

The behaviour of the bridge is measured when subjected to five load cases. Figure 4 shows load cases *LP-1* and *LP-2*, and reference axes that are used to illustrate measurement locations. For the third load case *LP-3*, the truck *T1* is placed at the same position as in *LP-2* and the second truck *T2* is positioned right behind it. For load cases *LP-4* and *LP-5*, the two trucks are placed alone on the bridge in their same respective positions as in *LP-2*. Load cases *LP-2*, *LP-3* and *LP-5* are used to verify the assumption of linear structural response.



**FIGURE 4 – TOP VIEW OF LANGENSAND BRIDGE WITH REFERENCE AXES FOR MEASUREMENT LOCATIONS**

The following types of measurements are taken during the static-load tests:

- displacement measurements are taken at six locations (at the intersections of the axes: S7-112, S7-116, S12-112, S12-116, S17-112 and S17-116) with optical devices
- rotations about the Z-axis are measured using two inclinometers placed near the abutment (at the intersection of the axes: A1-112 and S7-112).
- strains are measured at three locations on the bridge along the section S13 using SOFO Michelson-type fiber-optic sensors. Two sensors are placed along the X-direction over the centre of the main steel box girder such that one is embedded near the top of the concrete deck

and the other near the bottom of the concrete deck. The third sensor is placed on the top side of the bottom chord of the steel girder.

Figure 5 shows a detailed cross-section of the finite element representation from which possible behavioral models are generated. The structure consists of a steel girder plus a concrete slab and barrier. Shear connectors are provided on the top chord of the steel girder in order to allow for composite interaction between the steel and concrete components. The whole model is implemented in the software ANSYS (2007). The girder elements (steel plated and composite deck) are made of 8-nodes shells (SHELL281). The stiffeners flanges are modeled as 3-nodes beam elements (BEAM189). The concrete barrier is represented as tri-dimensional 20-nodes solid elements (SOLID186). The reinforcement is modeled by 2D smeared reinforcement (REINF265). The fixed bearing devices are implemented by fixing to zero displacement at the corresponding degree of freedom (DOF) in the required directions. A partial restriction to the free longitudinal movement of the bridge is imposed via one-dimensional spring elements (COMBIN14). This restriction is applied at the intersection of the concrete slab and barrier at right of the axis A1. The model has approximately 24K elements and 335K degrees of freedom requiring 1.6 Gb of RAM in order to be solved incore (ANSYS 2007). Each resolution of the model takes between 15 to 30 seconds depending on the CPU used. Note that the post-processing of the models is completely automated using ANSYS APDL programming language. Therefore this process is included in the solving time.

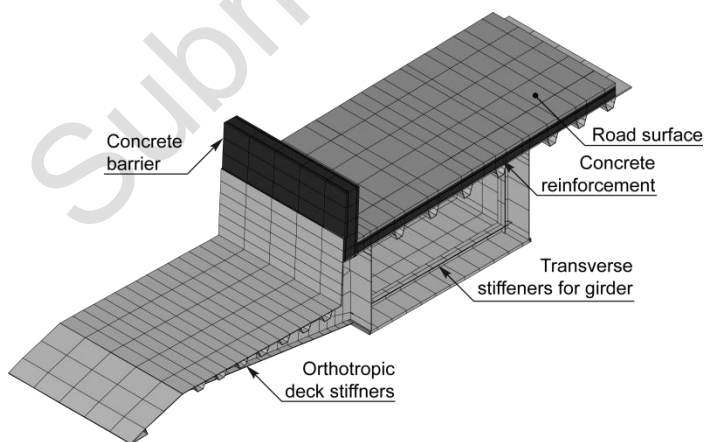

**FIGURE 5 - LANGENSAND BRIDGE CROSS-SECTION OF FINITE ELEMENT MODEL**

Researchers (Broquet et al. 2004; Chung et al. 2006; Conner and Huo 2006; Eamon and Nowak 2002; Eamon and Nowak 2004; Hassan 1994; Mabsout et al. 1997) have already shown that sidewalks and barriers may significantly affect the load and stress distribution in a structure. These results are also corroborated by a study conducted by the authors (Goulet et al. 2009), which showed that factors such as deck inclination, steel reinforcement and road surface should not be neglected when conducting a system identification study. Therefore an attempt is made to model all elements of the bridge that may contribute significantly to the stiffness of the structure including secondary structural elements such as stiffeners, concrete reinforcement, and road surface.

### 3.2. CANDIDATE MODEL SELECTION PROCESS

#### MODEL GENERATION

Several parameters are initially included in the general finite element model. However, the influence of uncertainties in parameters such as element thickness, rebar position and Young's modulus of pavement on predicted response is observed to be very small (i.e. <1%). The values for these parameters cannot therefore be accurately estimated using the measurements from the load-tests. The main parameters of interest are found to be the Young's modulus of steel, the Young's modulus of concrete and the stiffness of the bearing device restriction. These parameters follow a Gaussian distribution with means and standard deviations given in Table 1. If a negative value is sampled for the stiffness of the bearing device movement restriction, the parameter value is taken as zero.

**TABLE 1 - PARAMETERS ENTERING IN MODEL COMPOSITION**

	Average ( $\mu$ )	Std. Deviation ( $\sigma$ )
Young's modulus of steel	206 GPa	6 GPa
Young's modulus of concrete	37 GPa	2 GPa
Bearing device mvt. restriction	300 kN/mm	100 kN/mm

Starting from a general finite element model as presented in previous sections, potential behavioral models (*PM*) having a range of values for parameters and representing multiple models of structural

behavior are generated. The Latin Hypercube sampling method (*LHS*) is used to generate more than 1000 models. Each model is analyzed for the three load cases and the predictions at 11 locations for each case are recorded (i.e. six displacement points, two rotation and three strains). The total required time to obtain the initial model set is in the range of a few hours for common desk side computers.

## UNCERTAINTIES

Measurement and modeling uncertainties arising from the sources listed in Section 2 are systematically assessed as follows.

### MEASUREMENT UNCERTAINTIES

- Sensor accuracies are partially defined by resolution specifications from the manufacturer. In the case of electrical devices the sensor accuracy is taken as twice the specified resolution to take into account cable and contact losses as well as site conditions.
- The movement from ambient vibrations of the bridge and the sensors are filtered out by taking an average value over multiple samples. Since the noise recorded is assumed to be random, the average value tends toward the true measurand. The upper bound for uncertainty is computed as three times the standard deviation of the recorded samples. Moreover, in-between each measurement and the application or removal of loads on the bridge, there is a one minute period without activity on the bridge to allow for the attenuation of vibrations.
- The upper bound for the uncertainties associated with truck positioning and repeatability of measurements is evaluated by repeating each load case three times. A factor of three times the standard deviation obtained from the measurements of a given load case provides a confidence level of approximately 97% (for three samples).
- The effects of uncertainties in truck weights are evaluated according to engineering judgment.
- Temperature effects are eliminated by taking measurements over a short period of time for each load case.

### HYPOTHESIS AND MODELING UNCERTAINTIES

- Modeling experience and judgment are used to reduce and quantify uncertainties that originate from using the finite element method (FEM).
- Mesh discretization accuracy is estimated using mesh refinement studies. The values chosen are corroborated with those found in the literature (Topkaya et al. 2008).
- Uncertainties in geometry are eliminated by using a numerical model that uses dimensions taken from the “as-built” structure.
- A fundamental hypothesis in the simulations is that the structure behaves linearly with respect to the loading. This aspect implies linear material properties, and geometric linearity. To verify this hypothesis, measurements from load cases *LP-4* and *LP-5* are algebraically summed and compared with those from *LP-2*. The structural behavior is assumed to be linear if the difference between the two quantities is less than the respective measurement uncertainties. Otherwise, the uncertainty in model predictions is appropriately increased to account for the violation of this assumption.
- Bearing devices and loads are assumed to be concentrated loads. This simplification of the real structure is valid if the results are used for understanding the global behavior of the bridge.

Table 2 summarizes uncertainty sources and quantifies the extent of uncertainties from each of them for this structural identification task.

**TABLE 2- UNCERTAINTY SOURCES**

Uncertainty sources	Quantification method	PDF	Uncertainty according to the type of measurement			
			Displacements	Rotations	Strains	
Measurement uncertainties	Sensor accuracy	Manufacturer specified resolution	Uniform	$\pm 0.1$ mm	$\pm 1 \times 10^{-6}$ rad	$\pm 2$ $\mu\epsilon$
	Sensor noise from ambient vibration of the bridge	Average taken over multiple samples	Gaussian	$\pm 3\sigma$	$\pm 3\sigma$	$\pm 3\sigma$
	Repeatability & Truck positioning	Use value from multiple samples to determine a maximum uncertainty	Gaussian	$\pm 3\sigma$	$\pm 3\sigma$	$\pm 3\sigma$
	Truck weight	Truck weight variations have a linear response on the structure	Uniform	$\approx \pm 1.5\%$	$\approx \pm 1.5\%$	$\approx \pm 1.5\%$
	Temperature effects	Measurements for each load case taken over a short period of time	Uniform	$\approx 0\%$	$\approx 0\%$	$\approx 0\%$
Hypothesis and	Finite element method	Approximate value based on experience	Uniform	$\approx \pm 5\%$	$\approx \pm 5\%$	$\approx \pm 5\%$

modeling uncertainties	Mesh discretization	Upper bound based on a mesh refinement study	Uniform	≈0%	≈0%	≈±5%
	Model exactitude	Model "as built"	Uniform	≈0%	≈0%	≈0%
	Linear elastic behavior	Superposition of load cases	Uniform	≈0%	≈1%	≈0%
	Bearing devices represented as point loads	Negligible effect on the global behavior of the structure	Uniform	≈0%	≈0%	≈0%
	Truck wheels considered as point loads	Negligible effect on the global behavior of the structure	Uniform	≈0%	≈0%	≈0%

The differences between results from superposition ( $\Delta_{\text{linear}}$ ) of load cases *LP-4* and *LP-5* and those from *LP-2* are much lower than the corresponding measurement uncertainty in strains and displacements and the contrary for rotations. Thus the assumption of linear elastic behavior is verified from all measurements except rotations. The discrepancy with respect to rotations is attributed to the additional uncertainty in rotation predictions. To account for this aspect, the uncertainty in rotation predictions is increased by 1%.

Figure 6 shows the contributions of the main uncertainty sources for each measurement type. The figure identifies the factors that are the most important with respect to identifying the correct behavioral model. Uncertainties related to the finite element model accuracy and repeatability of the experiment are the most significant. Sensor accuracy is not the most significant source of uncertainty according to the results. Thus, choosing more accurate sensors will not necessarily help in identifying the correct behavioral model. However, having a FE model which better represent the real structure may help in identifying a smaller set of candidate models. Repeating the measurements many more times may also reduce standard deviations associated with repeatability and thus improve the quality of system identification.

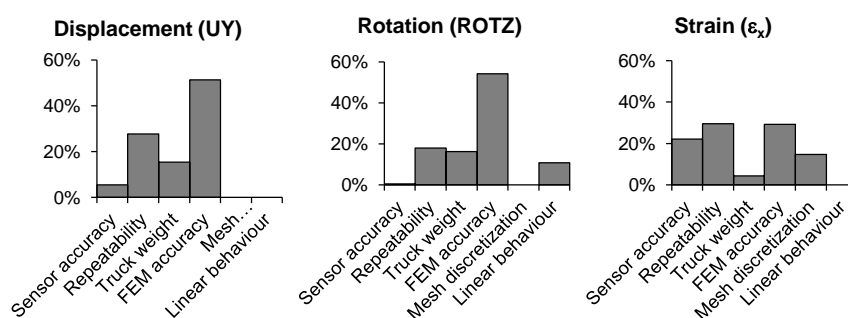

FIGURE 6 - UNCERTAINTY CONTRIBUTION BY SOURCE FOR EACH SENSOR TYPE

Figure 7 presents the percentage of uncertainties for each measurement type that are aleatory and epistemic (bias). In this case, aleatory uncertainties are smaller than the epistemic ones.

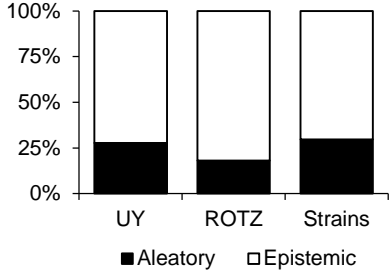

FIGURE 7 – ALEATORY AND EPISTEMIC UNCERTAINTIES FOR EACH MEASUREMENT TYPE

### 3.3. RESULTS

The multi-model candidate selection approach described in section 2 is applied to the set of potential behavioral models (1'000 models). The process and the resulting set of candidate models are summarized in Figure 8. This figure shows that the candidate models which are representative of the structure’s measured behavior are not those that minimize the discrepancy between measured and predicted values. Moreover, it exhibits the epistemic (biased) character of uncertainties in finite element simulations.

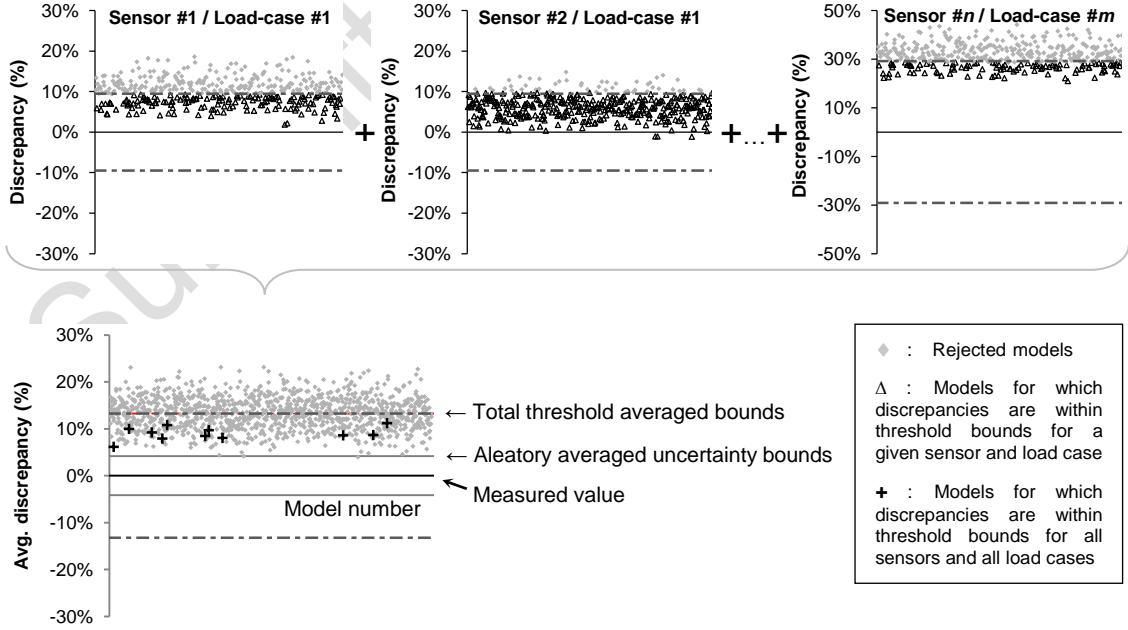

FIGURE 8 – CANDIDATE MODEL SELECTION PROCESS USING THRESHOLD



## IDENTIFIED BEHAVIORAL CHARACTERISTICS

The candidate model selection methodology initially identified 152 models which may predict the measured behavior while considering uncertainty. An additional filter is applied in order to discard models showing unexpected parameters values. The main characteristics of the eleven identified candidate models as well as the bounds used as plausible values are presented in Table 3. These results indicate that the *CM* set is able to predict the measured displacements and rotations of the structure to an accuracy of 4 to 7 %. Strains are more difficult to assess. The deviations range from 15 to 23% compared to the measurements. The predictions from the model set provide ranges narrower than than the one from which the real behavior of the structure is expected. Model characteristics are discussed in detail in the following section.

**TABLE 3 - CANDIDATE MODEL PROPERTIES**

Model number	Bearing device stiffness (kN/mm) [0-325]	Young's modulus (GPa)		Averaged prediction/measurement ratio	
		Steel	Concrete	ROTZ & UY	$\epsilon_y$
		[200-212]	[29-45]		
1	300	210.2	36.8	1.06	1.20
2	320	206.6	39.2	1.05	1.18
3	300	210.7	36.5	1.07	1.22
4	270	208.3	37.9	1.05	1.19
5	270	211.9	35.8	1.07	1.23
6	250	211.9	38.7	1.05	1.17
7	260	210.5	37.9	1.05	1.19
8	280	211.7	38.6	1.04	1.18
9	300	211.2	41.7	1.04	1.15
10	210	211.7	36.9	1.06	1.20
11	310	211.5	38.4	1.05	1.18

## BEARING DEVICES WITH RESTRAINED DISPLACEMENT

After interpretation of measurements from the static-load tests, many candidate models with constrained longitudinal movement were identified to be candidate models. Visual inspection of the bearing device shows no symptoms of malfunction. Additional inspections of the expansion junction device revealed that the extremity of the bridge where the longitudinal movement is intended to be free was restrained. Two wooden blocks were left in place between the abutment and the concrete barrier of the bridge. The location and dimension in millimeters of these blocks is shown in Figure 9. A closer inspection revealed that the blocks were prestressed by the weight of the structure (i.e. they

were impossible to remove manually) and they showed an elastic behavior under the passage of trucks on the bridge. From calculations using wood material proprieties (DOA 1999) the stiffness of the restraint is estimated to be 300kN/mm.

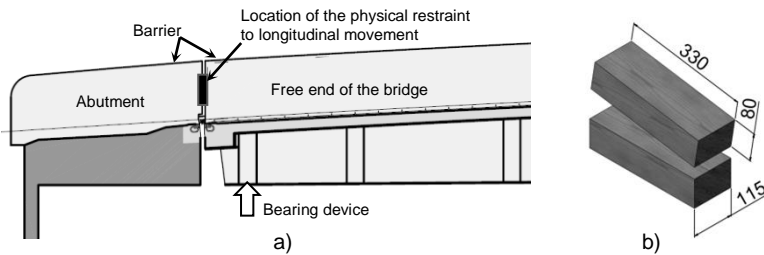

**FIGURE 9 – A) REPRESENTATION AND POSITION OF THE DISPLACEMENT RESTRICTION B) DIMENSIONS OF THE WOODEN BLOCKS (MM)**

Candidate models have values for bearing device stiffness between 200 and 320 kN/mm. Even if the nominal value of the stiffness of the restraint is large, its effect on the structure remains small ( $\approx 1-3\%$  for displacement predictions). Therefore, identifying the exact value for this parameter is difficult.

#### MATERIAL PROPRIETIES

Candidate models having values for material proprieties that are within the plausible values are identified. It confirms that the behavior of the structure conforms to expectations. The values for Young's modulus of steel and concrete range from 206 GPa to 212 GPa and from 36 GPa to 42 GPa respectively.

#### COMPOSITE INTERACTION

The design hypothesis related to composite interaction between the concrete and steel deck is verified by the candidate models. Results from measurements show no sign of partial interaction between the concrete deck and the steel girder under service loads. Candidate models having partial composite interaction also have unrealistic values for material proprieties to compensate for the additional flexibility introduced by this feature. Therefore, if the effect is present, it is not significant enough to be distinguished from fully composite interaction and it would not significantly alter the in-service behavior of the structure.

## 4. IMPROVEMENT OVER CLASSICAL MODEL UPDATING

A trivial model updating is performed using the measurements for the purpose of comparison with results from multi-model approach. The objective is to show through a simple example that aiming to fit predicted values to measurements is likely to lead to a biased solution if the uncertainties are not considered. In this case, an analytical formulation for the beam displacement is used for the model-updating approach. This model has been chosen especially because it is not an exact representation of the reality. Vertical displacement predictions from the design model (provided by the engineer in charge of the design), the model obtained by model updating and candidate models from multi-model approach are compared for a critical risk situation ( $E_d$ ) prescribed in Swiss SIA design codes (SIA 2003). In equation 1,  $E_d$  represents the displacement in millimeters under the combination of 75% of the lane load plus the concentrated forces and 40% of the sidewalk load.

$$E_d = 0.75 \cdot L_{Lane} + 0.40 \cdot L_{Sidewalk} \quad (1)$$

This load distribution is shown in Figure 10.

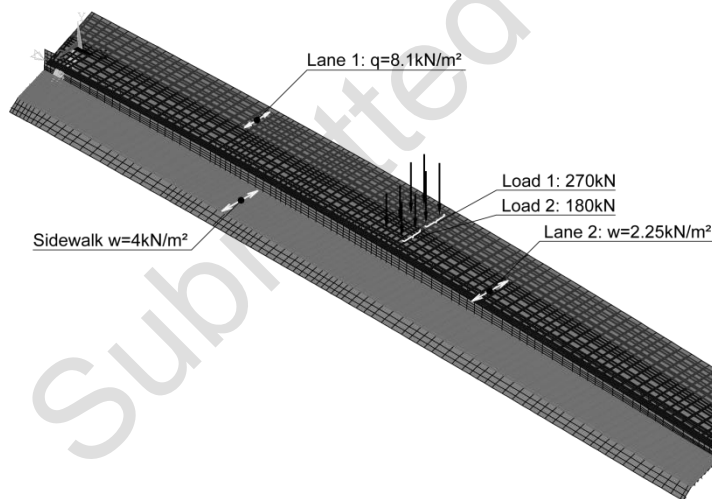

FIGURE 10 - LOADS FOR RISK SITUATION  $E_D$  APPLIED ON THE COMPLETE MODEL

### 4.1. SINGLE MODEL UPDATING

Bernoulli beam theory is used to determine the equivalent flexural stiffness of the bridge from the measurements. The relations for displacement and rotation measurements are presented in equations 2 and 3. A representation of the updated model is presented in Figure 11.

$$EI_{eq} = \frac{Px}{48 \cdot (UY)_{meas}} (3L^2 - 4x^2) \quad 0 \leq x \leq \frac{L}{2} \tag{2}$$

$$EI_{eq} = \frac{P}{16 \cdot (ROTZ)_{meas}} (L^2 - 4x^2) \quad 0 \leq x \leq \frac{L}{2} \tag{3}$$

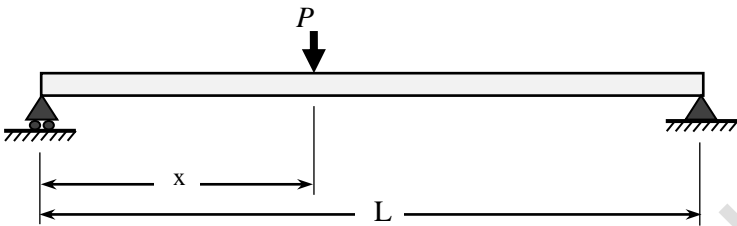

FIGURE 11- BEAM-BASED UPDATED MODEL

Measurements from one load case are used to compute the equivalent flexural stiffness of the bridge. Using the four measurements and equations (2) and (3), the average flexural stiffness is evaluated. One of the results are presented in Table 4.

TABLE 4 - EQUIVALENT RIGIDITY FOUND WITH AN UPDATING METHOD

		$EI_{eq}$
Measurement		( $\times 10^{17}$ N.mm <sup>2</sup> )
Displacement	S07-112	2.74
	UY S12-112	2.63
Rotation	A0-112	2.64
	ROTZ A7-112	3.02
Average		2.75

This approach evaluates an equation that implicitly includes the stiffness of every element of the bridge. Therefore, it is not possible to determine the capacity of the structure without the barrier or the capacity without the abutment restriction that was present during the load tests. In the case of the multi-model approach, the abutment restriction has been removed in order to obtain the response of the structure in service.

The model updating approach has also been applied to the complete finite element model presented in Figure 10. The model has been manually calibrated to fit displacement or strain measurements. Possible values for Young's modulus of steel and for concrete are 235 GPa and 43 GPa respectively when the model is calibrated using strain measurements and 211 GPa and 47 GPa when the model is calibrated using displacements. This simple example shows that using two different sets of measurements from the same load tests can lead to two different results which are not realistic. The values obtained from traditional model updating are questionable since parameters values may have compensated for epistemic uncertainties present in measurements or in the model.

#### 4.2. COMPARISON OF APPROACHES

The stiffness estimated with model updating is used to predict the maximal displacement of the bridge under the risk situation  $E_d$ . This result using beam model (Figure 11) is shown in Table 5. The table includes the predictions of the model obtained by calibrating the finite element model (Figure 10) and the candidate models from the multi-model approach (Table 3). The table also gives the predictions from the model used by the designer. Note that the design model does not consider the concrete barrier as per the owner's requirement.

**TABLE 5 - VERTICAL DISPLACEMENT UNDER SIA (SIA 2003) RISK SITUATION E<sub>d</sub>**

Approach	Maximum vertical displacement for risk situation E <sub>d</sub> (mm)	
Updated model	Beam model (Figure 11) Updated using UY&ROTZ	73.0
	Complete model (Figure 10) Updated using UY	78.1
	Complete model (Figure 10) Updated using strains	76.5
	Multi-models	82.1 - 84.5
Design-model	117.8	

The results in Table 5 show that traditional model updating may not be reliable since it underestimates the vertical displacement. However, the design-model provides safe and conservative predictions as expected. Evaluating the real displacement of the structure for the loading E<sub>d</sub> requires conducting an equivalent load test on the structure.

We may therefore see that it is possible to find a model which exactly fits measurements without being the right one. Even when sophisticated FEM models are used, there are always uncertainties associated with them (in addition to the uncertainties in the other process ex: measurements). Uncertainties associated with civil engineering structures cannot all be represented as aleatory and independent at each measured DOF. For example, the uncertainty associated to FEM is epistemic making every prediction biased compared to the reality. The same reasoning is also applicable for some advanced model updating techniques. Whenever the goal is to fit model predictions to measured data, the result will be biased by the errors occurring in the process (modeling and measurement). As mentioned by Tarantola (2006) using observations to infer one model of the system (the ‘best model’ or the ‘mean model’ or whatever) is wrong. For different sets of measurements, model updating leads to different models. In their guide for validation in solid mechanics ASME (2006) mentioned that parametric model calibration (in which lies model-updating) determines only the model’s fitting ability not its predictive one. In the case of the multi-model approach, the uncertainties are acknowledged and assessed, thereby increasing the confidence in the obtained results. Results presented in Table 5 indicate that the multi-model approach provides a more conservative solution than what is obtained

from model updating. Table 5 also shows that the bridge has a reserve deflection capacity of 30 % for service loads when compared to the value predicted by the design model.

## 5. DISCUSSION

Predictions resulting from the set of candidate models are homogenous. Even if uncertainties concerning material properties are present, their effects on predictions are limited. The discrepancy between the predictions from the set of candidate models and the measurements reflects the approximate nature of finite element method and the importance of epistemic uncertainties. Models are always an approximation of the reality. Therefore trying to minimize the discrepancy between predicted and measured values by adjusting parameter values would inevitably lead to a biased solution. The parameter sets that exactly match the measured value are not representative of the real structure, but only of an approximate idealization of it. The set of candidate models obtained may be used to assess the displacement behavior of the full bridge prior to its construction to an accuracy of 7%. This goes along with the idea that there are multiple possible solutions for inverse tasks such as structural identification.

The quantification of modeling uncertainties used in this study is based on preliminary studies or on experienced judgment. If the uncertainties are not adequately evaluated, the results are prone to be biased. Although it is important to remember that for any identification approach, one should consider and quantify these in a similar way as it is done in this study. In this case, if one increases the uncertainties because of a lack of knowledge about them, the number of candidate models found would also rise up, and the opposite is also true.

Trust in the solution may be increased by quantifying these quantities on the basis of well-designed experiments. Comparing simple (beam-based) to advanced (shell & solid based) models may only give a lower bound for the uncertainties associated with these simple models. In this case, the most advanced model which is currently possible to solve is used to represent the structure. Therefore, no information is available in order to quantify the uncertainty associated with the model other than

engineering judgment. Moreover, the quality of the results may also be improved by using a systematic approach for measurement system design prior to the load tests. For the case study presented in this paper, such an approach was not possible due to time constraints.

## 6. CONCLUSION

The conclusions of this research are:

- The multi-model approach is applicable for structural identification and performance monitoring of real structures. Considering uncertainties explicitly during the identification process is feasible. Neglecting them may lead to a biased identification.
- A major component of uncertainty has an epistemic nature. Therefore, assuming that uncertainties are exclusively aleatory and independent at each measured DOF is inappropriate for bridge identification tasks, such as the one presented here.
- The set of candidate models that are identified for the Langensand Bridge improve the understanding of its structure behavior. These models are able to predict the response of the structure to within 7% of measured values.
- The results have enabled the verification of the design hypothesis considering the bridge as composite. This assumption has been tested and results reveal that for the tested loads the bridge behaves in a fully composite manner.

A continuation of this study is currently under way in order to further validate these results and obtain better evaluation of the uncertainties. Ambient vibration recording from dynamic testing of the bridge is used to crosscheck results. Future work will focus on assessing the uncertainties when using finite element analyses to model bridge behavior in order to increase confidence in results. Also, studies using new statistical approaches are underway to develop a systematic methodology to include uncertainty in the determination of the threshold value. Moreover, new developments are currently being implemented for measurement system design in order to increase the robustness and efficiency



of structural system identification tasks. Such a study also aims to reduce the cost of structural performance monitoring, through minimizing the number of sensors used.

## 7. ACKNOWLEDGEMENTS

Collaboration with the designers of the Langensand Bridge - Gabriele Guscetti and Claudio Pirazzi (Guscetti & Tournier), was important for successful completion of the load tests. The authors also acknowledge input from Dr. R. Cantieni and the help we received from his team when taking the measurements. Finally the authors would like to thank – I. Laory and P. Gallay for their help during load testing. The city of Lucerne provided logistics support, the trucks for the load tests and the deformation sensors. This research is funded by the Swiss National Science Foundation under contract no. 200020-117670/1.

## REFERENCES

- ANSYS. (2007). "Theory Reference for ANSYS and ANSYS Workbench." ANSYS, Inc., Southpointe.
- ASME, A. S. o. M. E. (2006). "Guide for Verification and Validation in Computational solid Mechanics." ASME V&V 10-2006, New-York.
- Banan, M. R., and Hjelmstad, K. D. (1994). "Parameter-Estimation of Structures From Static Response .1. Computational Aspects." *Journal of Structural Engineering-Asce*, 120(11), 3243-3258.
- Beck, J. L., and Katafygiotis, L. S. (1998). "Updating Models and Their Uncertainties. I: Bayesian Statistical Framework." *Journal of Engineering Mechanics*, 124(4), 455-461.
- Broquet, C., Bailey, S. F., Fafard, M., and Bruhwiler, E. (2004). "Dynamic Behavior of Deck Slabs of Concrete Road Bridges." *Journal of Bridge Engineering*, 9(2), 137-146.
- Brownjohn, J. M. W. (2007). "Structural health monitoring of civil infrastructure." *Philosophical Transactions of the Royal Society A: Mathematical, Physical and Engineering Sciences*, 365(1851), 589-622.
- Brownjohn, J. M. W., Moyo, P., Omenzetter, P., and Lu, Y. (2003). "Assessment of Highway Bridge Upgrading by Dynamic Testing and Finite-Element Model Updating." *Journal of Bridge Engineering*, 8(3), 162-172.
- Brownjohn, J. M. W., and Xia, P.-Q. (2000). "Dynamic Assessment of Curved Cable-Stayed Bridge by Model Updating." *Journal of Structural Engineering*, 126(2), 252-260.
- Catbas, F. N., Susoy, M., and Frangopol, D. M. (2008). "Structural health monitoring and reliability estimation: Long span truss bridge application with environmental monitoring data." *Engineering Structures*, 30(9), 2347-2359.
- Chung, W., Liu, J., and Sotelino, E. D. (2006). "Influence of Secondary Elements and Deck Cracking on the Lateral Load Distribution of Steel Girder Bridges." *Journal of Bridge Engineering*, 11(2), 178-187.
- Conner, S., and Huo, X. S. (2006). "Influence of Parapets and Aspect Ratio on Live-Load Distribution." *Journal of Bridge Engineering*, 11(2), 188-196.
- DOA, D. o. A., Forest Service. (1999). "Wood Handbook - Wood as an Engineering Material. Gen. Tech. Rep.", Forest Product Laboratory, Madison, WI: US, 463 p.
- Eamon, C. D., and Nowak, A. S. (2002). "Effects of Edge-Stiffening Elements and Diaphragms on Bridge Resistance and Load Distribution." *Journal of Bridge Engineering*, 7(5), 258-266.
- Eamon, C. D., and Nowak, A. S. (2004). "Effect of secondary elements on bridge structural system reliability considering moment capacity." *Structural Safety*, 26(1), 29-47.

- Goulet, J.-A., Kripakaran, P., and Smith, I. F. C. (2009). "Estimation of modelling errors in structural system identification." 4th International Conference on Structural Health Monitoring on Intelligent Infrastructure (SHMII-4), Zurich, Switzerland.
- Hadidi, R., and Gucunski, N. (2008). "Probabilistic Approach to the Solution of Inverse Problems in Civil Engineering." *Journal of Computing in Civil Engineering*, 22(6), 338-347.
- Hassan, M. (1994). "Critères decoulant d'essais de charge pour l'évaluation du comportement des ponts en béton et pour le choix de la précontrainte," École Polytechnique Fédérale de Lausanne, Lausanne.
- He, X., Moaveni, B., Conte, J. P., Elgamal, A., and Masri, S. F. (2009). "System Identification of Alfred Zampa Memorial Bridge Using Dynamic Field Test Data." *Journal of Structural Engineering*, 135(1), 54-66.
- Ljung, L. (1999). "System Identification Theory for User." P. Hall, ed., New Jersey.
- Mabsout, M. E., Tarhini, K. M., Frederick, G. R., and Kobrosly, M. (1997). "Influence of Sidewalks and Railings on Wheel Load Distribution in Steel Girder Bridges." *Journal of Bridge Engineering*, 2(3), 88-96.
- McKay, M. D., Beckman, R. J., and Conover, W. J. (1979). "A Comparison of Three Methods for Selecting Values of Input Variables in the Analysis of Output from a Computer Code." *Technometrics*, 21(2), 239-245.
- Moon, F. L., and Aktan, A. E. (2006). "Impacts of Epistemic (bias) Uncertainty on Structural Identification of Constructed (Civil) System." *The Shock and Vibration Digest*, Vol. 38(No. 5), 399-420.
- Morassi, A., and Tonon, S. (2008). "Dynamic Testing for Structural Identification of a Bridge." *Journal of Bridge Engineering*, 13(6), 573-585.
- Oberkampf, W. L., DeLand, S. M., Rutherford, B. M., Diegert, K. V., and Alvin, K. F. (2002). "Error and uncertainty in modeling and simulation." *Reliability Engineering & System Safety*, 75(3), 333-357.
- Raphael, B., and Smith, I. (1998). "Finding the right model for bridge diagnosis." *Artificial Intelligence in Structural Engineering in Computer Science*, Springer, Heidelberg, 308-319.
- Raphael, B., and Smith, I. F. C. (2003). "A direct stochastic algorithm for global search." *Applied Mathematics and Computation*, 146(2-3), 729-758.
- Robert-Nicoud, Y., Raphael, B., Burdet, O., and Smith, I. F. C. (2005a). "Model identification of bridges using measurement data." *Computer-Aided Civil and Infrastructure Engineering*, 20(2), 118-131.
- Robert-Nicoud, Y., Raphael, B., and Smith, I. F. C. (2005b). "System Identification through Model Composition and Stochastic Search." *Journal of Computing in Civil Engineering*, 19(3), 239-247.
- Saitta, S., Kripakaran, P., Raphael, B., and Smith, I. F. C. (2008). "Improving System Identification Using Clustering." *Journal of Computing in Civil Engineering*, 22(5), 292-302.
- Saitta, S., Kripakaran, P., Raphael, B., and Smith, I. F. C. (2009). "Feature selection using stochastic search: An application to system identification."
- Sanayei, M., and Saletnik, M. J. (1996). "Parameter estimation of structures from static strain measurements .1. Formulation." *Journal of Structural Engineering-Asce*, 122(5), 555-562.
- SIA. (2003). "Actions sur les structures porteuses." SN 505 261, Zurich, 104 p.
- Tarantola, A. (2006). "Popper, Bayes and the inverse problem." *Nat Phys*, 2(8), 492-494.
- Teughels, A., and De Roeck, G. (2004). "Structural damage identification of the highway bridge Z24 by FE model updating." *Journal of Sound and Vibration*, 278(3), 589-610.
- Topkaya, C., Kalayci, A. S., and Williamson, E. B. (2008). "Solver and Shell Element Performances for Curved Bridge Analysis." *Journal of Bridge Engineering*, 13(4), 418-424.